



10 Burleigh Gardens, Ashford, TW15 1EQ

£559,000

10 Burleigh Gardens, Ashford, TW15 1EQ

Immaculately presented throughout, this attractive three bedroom extended semi-detached bungalow is tucked away in one of Ashford's most sought-after cul-de-sac locations. Ideally positioned within walking distance of the town centre, local shops and nearby recreation parks, the property offers a perfect blend of convenience and peaceful residential living. The accommodation has been thoughtfully extended and maintained, featuring a spacious and light-filled lounge/diner, a modern fitted kitchen and a stylish contemporary bathroom.

Externally, the home continues to impress with off-street parking and a good-sized detached garage, providing excellent storage or further potential. The beautifully landscaped rear garden is a particular highlight, offering a mature and sunny setting ideal for relaxing or entertaining. This superb bungalow is perfectly suited to downsizers, families or anyone seeking a ready-to-move-into home in a highly desirable location. Call Ashford's market leading sales team at Aspen estate agents.



Floor Plan

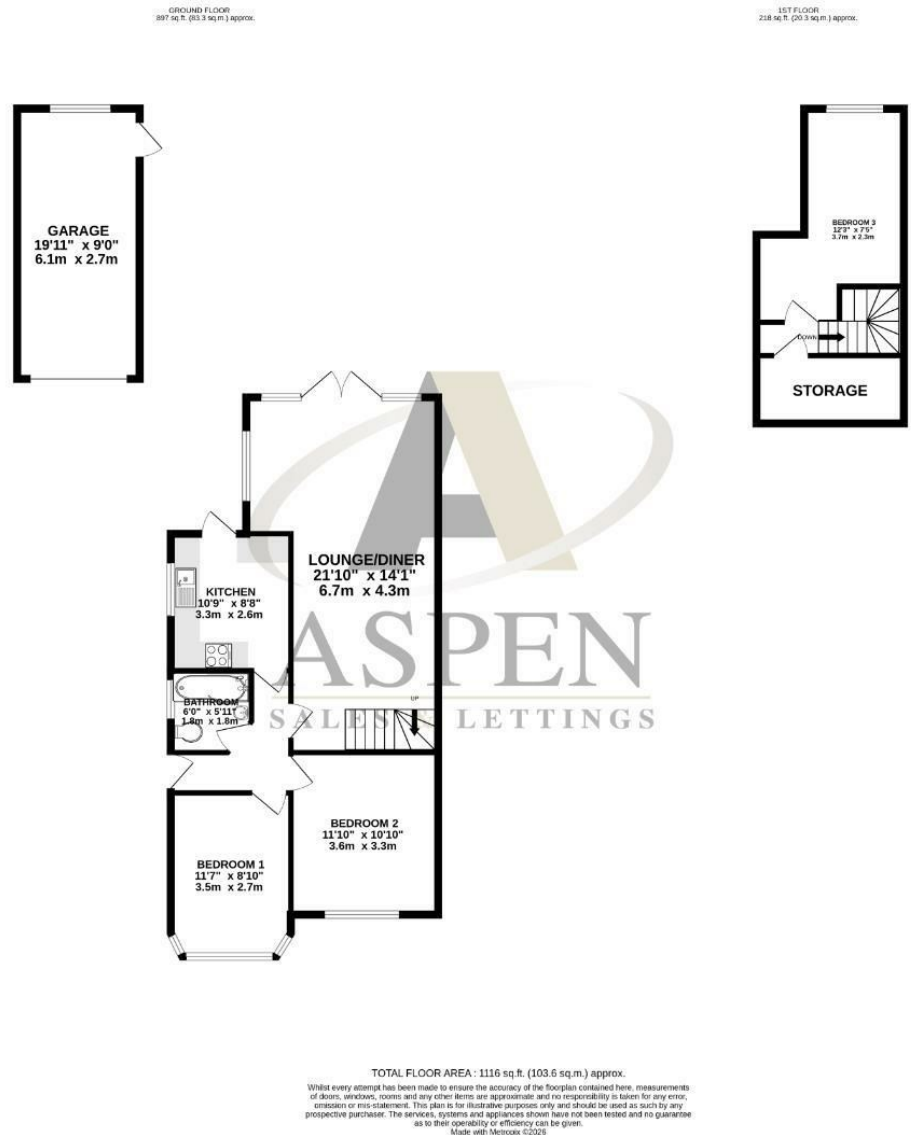

Features

- Immaculately presented three bedroom extended semi-detached bungalow
- Within walking distance of the town centre, shops and recreation parks
- Modern fitted kitchen with contemporary finishes
- Off-street parking for added convenience
- Beautifully landscaped, mature rear garden enjoying a sunny aspect
- Located in a highly desirable quiet cul-de-sac in Ashford
- Spacious and bright extended lounge/diner ideal for entertaining
- Stylish and well-appointed modern bathroom
- Good-sized detached garage offering storage or potential use
- Ideal for downsizers, families or buyers seeking a move-in ready home

Aspen Residential Services
77 Church Road, Ashford, Surrey, TW15 2PE
Tel: 01784 252 202
Email: enquiries@aspensalesandlettings.com

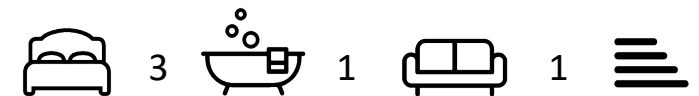

Tenure - Freehold Council Tax Band - E

